



OpticsPro X Series

OpticsPro X

Channel Letter & Sign Cabinet Lighting



OpticsPro X Lite Bright White (XPRO-M3LT-BW65)

features

- New easy-peel double-sided tape
- Superior brightness with improved efficacy over the previous generation
- New and improved optics with 162° beam angle
- Flexible wires allowing easier handling and wire management
- Engineered with Top Tier LED chips and equipped with Bitro's Constant Current Technology
- High quality parts and reliable manufacturing for excellent performance
- Designed for uniform illumination with durable, dependable and long-lasting construction
- Engineered for maximum efficiency and minimum voltage drop
- Backed by 7/5-year Limited Warranty (Product/Labor)

overview

OpticsPro X (XPRO) series is one of the Bitro's premium channel letter lighting products that is affordable yet still powerful. Using optical lens technology for true wide beam spread, XPRO can reduce both labor and material cost without sacrificing uniform illumination and brightness intensity.

The lens also performs as a protective cover for its excellent water-resistant and dust-free design.

models	description
XPRO-M3	"OpticsPro X Max". Medium Body, 3-bulb Module 225 lm/ft, max 22.5 ft per 60W power supply
XPRO-M3PL	"OpticsPro X Plus". Medium Body, 3-bulb Module 180 lm/ft, max 30 ft per 60W power supply
XPRO-M3LT	"OpticsPro X Lite". Medium Body, 3-bulb Module 128 lm/ft, max 45 ft per 60W power supply

models & dimension

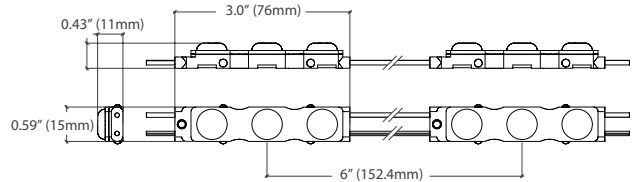

XPRO-M3	3-bulb, medium body, 2 modules per foot 236 lm/ft, max load: 22.5 ft on ASU-60-12U
XPRO-M3PL	3-bulb, medium body, 2 modules per foot 184 lm/ft, max load: 30 ft on ASU-60-12U
XPRO-M3LT	3-bulb, medium body, 2 modules per foot 136 lm/ft, max load: 45 ft on ASU-60-12U



Constant
Current
Technology

IP68

7/5-YEAR
LIMITED WARRANTY
PRODUCT/LABOR



LM80





OpticsPro X Series

OpticsPro X

Channel Letter & Sign Cabinet Lighting



specifications

Item	Series Name	OpticsPro X Series			
Model	Model Name	OpticsPro X Max	OpticsPro X Plus	OpticsPro X Lite	
	Model #	XPRO-M3	XPRO-M3PL	XPRO-M3LT	
	Intended Applications	Standard Channel Letters, Sign Cabinets			
	Physical Dimensions	3.00" x 0.59" x 0.43" (76mm x 15mm x 11mm)			
	# LED Bulbs per Module	3 lamps			
Applications	Module Spacing	2 mods/ft (6" on-center)			
	* Lumens	per Module	118 lm/mod	92 lm/mod	68 lm/mod
		per Foot	236 lm/ft	184 lm/ft	136 w/ft
Electrical	Power Consumption	per Module	1.2 w/mod	0.9 w/mod	0.63 w/mod
		per Foot	2.4 w/ft	1.8 w/ft	1.26 w/ft
	Recommended LED Power Supply	Alpha Slimline 12V-60W Class 2 Power Supply (ASU-60-12U)			
	Recommend- ed Load per Power Supply	# Modules	45 mods	60 mods	90 mods
		Linear Ft	22.5 linear ft	30 linear ft	45 linear ft
	* Lumen Efficacy (lm/w)	99 lm/w			
Colors, SKUs	Color	Color Specs	SKU's		
	Bright White	6500K	XPRO-M3-BW65	XPRO-M3PL-BW65	XPRO-M3LT-BW65
	Day White	5000K	XPRO-M3-DW50	XPRO-M3PL-DW50	XPRO-M3LT-DW50
	Soft White	4000K	n/a	XPRO-M3PL-SW40	n/a
	Warm White	3000K	n/a	XPRO-M3PL-WW30	n/a
Common Specs	Input Voltage	12VDC			
	Viewing Angle	162°			
	Operating Temperature	-25°C ~ 60°C / -13°F ~ 140°F			
	Housing	ABS styrene copolymer, Polycarbonate Optics			
	Wire	18AWG, 1007, UL Approved			
	Waterproof Rating	IP68. UL approved for Dry, Damp, and Wet** Locations			
	Application Method	Easy double-sided tape, Mounting Hole for Mechanical Fastening			
	Warranty	7/5-Year Limited Warranty (Product/Labor)			
	Certifications	UL Recognized (SAM) for US & Canada, CE, CSA			
	UL File # / Ref. #	BT-CLM "Channel Letter Modules" E341583 for cRUus, E487861 for Retrofit UL			
	CSA File # / Ref. #	258485, "BT-CLM"			
CE Ref. #	"BT-CLM"				

* Lumen values based on 6500K Bright White Model

** Direct exposure not recommended

revised: 03/22/2021

layout service

Please email estimate@bitrogroup.com
For prompt layout services, provide scaled & detail drawings.

contact bitro

Bitro Group, Inc. (Headquarters)
300 Lodi St. Hackensack, NJ 07601
201-641-1004
sales@bitrogroup.com



OpticsPro X Series

OpticsPro X

Channel Letter & Sign Cabinet Lighting



OpticsPro X Layout Guidelines

Recommended maximum spacing configuration for optimal uniformity¹

Depth ²	Maximum Single Stroke Coverage	Module-to-Module Parameters	
		Minimum Mods/ft	Mod-to-Mod Distance on Center
>7"	15"	2 mods/ft	6"
6"	14"	2 mods/ft	6"
5"	12"	2 mods/ft	6"
4"	9"	2.5 mods/ft	4.8"
3"	7"	3 mods/ft	4"
2.5"	5"	3.5 mods/ft	3.4"

Depth ²	Stroke-to-Stroke Spacing for multiple rows	Module-to-Module Parameters	
		Minimum Mods/ft	Mod-to-Mod Distance on Center
>7"	12"	2 mods/ft	6"
6"	11"	2 mods/ft	6"
5"	9"	2 mods/ft	6"
4"	7"	2.5 mods/ft	4.8"
3"	4.5"	3 mods/ft	4"
2.5"	2.5"	3.5 mods/ft	3.4"

* Parameters are tested on 3/16" 2447 White Acrylic Face.

* Layouts are applicable to OpticsPro X Max, Plus, and Lite. Brightness Level is proportional to relative current draw of the modules.

¹ Listed parameters are maximum spacing of modules required for uniform illumination of faces at any given depth.

* Configurations outside of listed parameters may be considered acceptable, depending on user testing.

² Module layout parameters at deeper depths (>6") may require additional modules per brightness considerations, irrespective of layout recommendation. Properties of optics lenses may impart unexpected results with specific layouts at shallow depths. Testing of module layouts at depths <3" is highly recommended.

revised: 03/22/2021

layout service

Please email estimate@bitrogroup.com
For prompt layout services, provide scaled & detail drawings.

contact bitro

Bitro Group, Inc. (Headquarters)
300 Lodi St. Hackensack, NJ 07601
201-641-1004
sales@bitrogroup.com