



DIAMOND ELP Series

Edgelit Snap-frame Graphic Panel

Ultrathin Edgelit LED Lighting Panels



overview

Allow Bitro to shine new light on your advertising methods with Bitro's Ultra-thin light panel. The modular design light box, which emanates with rich color and uniform brightness, can be customized for a wide variety of applications. In addition, its user-friendly design features bezels that snaps open forward for easy picture replacement, rounded corners for optimum safety, and a frame as thin as 3/4" in width for slim display. Begin enchancing your ads now by implementing this radiant light panel!

models & dimension

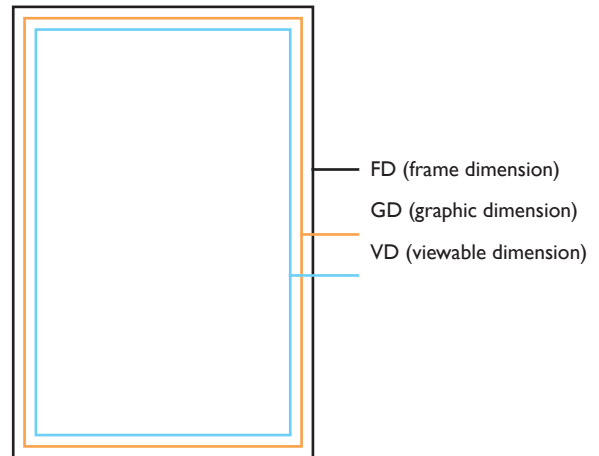

When you put a graphic into a Ultra-thin Edgelit frame, a 1/2" margin is covered by the frame.

features

- Great for advertisement, tradeshow, POP, menu board.
- Ultra slim design looks great on any wall
- Uniform Illumination with no hot spots
- Low energy consumption: over 40% energy savings over traditional light boxes
- Front load hatch frame makes changing graphics easy and fast
- Environmentally Friendly

how it works



as thin as 0.85"~1.97" in thickness

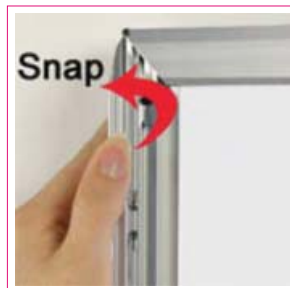

Bezel snaps open for easy picture replacement



Round corners for safety



DIAMOND ELP Series

Edgelit Snap-frame Graphic Panel

Ultrathin Edgelit LED Lighting Panels



specifications



layout service

Please email estimate@bitrogroup.com with drawings for prompt layout services.

contact bitro

Bitro Group, Inc. (Headquarter)
300 Lodi st. Hackensack, NJ 07601
201-641-1004 sales@bitrogroup.com

distributed by